



Felicity Adobe

Happy homes for all



Homes for all

Happy homes for all

Swarna Griha – 4 | Windmills By Your Side

Progress Report of Month April 2023

MASTER PLAN OF PHASE-1

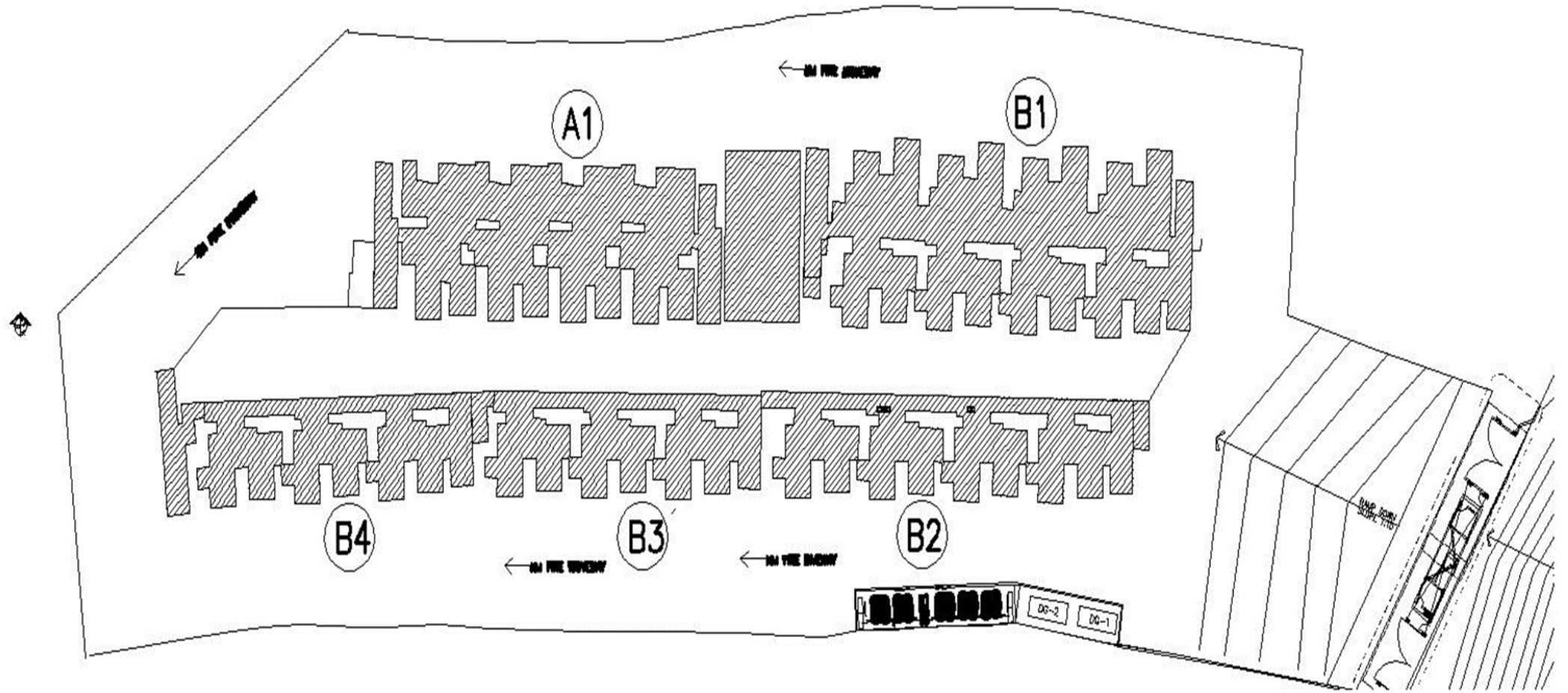

SG-4	PROJECT SUB-STRUCTUTE PROGRESS TREE OF PHASE-1						
FLOOR	WORK	B1	B2	B3	B4	A1	A4
GROUND FLOOR	CONCRETE	Completed				Completed	
	STEEL	Completed		Work In Progress		Completed	
	SHUTTERING	Completed		Completed	Work In Progress	Completed	
STILT FLOOR	STILT COLUMNS	Completed	Work In Progress	Completed	Completed	Completed	
	GRADE SLAB	Completed	Completed	Completed	Completed	Completed	
	ATT	Completed	Completed	Completed	Completed	Completed	
	PLINTH BEAMS	Completed	Completed	Completed	Completed	Completed	
	SOIL FILLING	Completed	Completed	Completed	Completed	Completed	
RAFT	CONCRETE	Completed	Completed	Completed	Completed	Completed	
	STEEL	Completed	Completed	Completed	Completed	Completed	
	PCC	Completed	Completed	Completed	Completed	Completed	Work In Progress
	EXCAVATION	Completed	Completed	Completed	Completed	Completed	Completed

SG-4		PROJECT SUPER-STRUCTURE PROGRESS TREE OF PHASE-1	
FLOOR	POUR	B1	A1
TERRACE	POUR-2		
	POUR-1		
12TH FLOOR	POUR-2		
	POUR-1		
11th FLOOR	POUR-2		
	POUR-1		
10TH FLOOR	POUR-2		
	POUR-1		
9TH FLOOR	POUR-2		
	POUR-1		
8TH FLOOR	POUR-2		
	POUR-1		
7TH FLOOR	POUR-2		
	POUR-1		
6TH FLOOR	POUR-2		
	POUR-1		
5TH FLOOR	POUR-2		
	POUR-1		
4TH FLOOR	POUR-2		
	POUR-1		
3RD FLOOR	POUR-2		
	POUR-1		
2ND FLOOR	POUR-2		
	POUR-1	Work In Progress	
1ST FLOOR	POUR-2	Work In Progress	
	POUR-1	Completed	
GROUND FLOOR	POUR-2	Completed	Work In Progress
	POUR-1	Completed	Work In Progress

APRIL



MARCH





1ST FLOOR ALUFORM WORK IN PROGRESS



1ST FLOOR SLAB REINFORCEMENT & ELECTRICAL CONDUITING WORK IN PROGRESS

APRIL



MARCH



APRIL



MARCH



APRIL



MARCH





B3 PODIUM SLAB SHUTTERING COMPLETED

APRIL



MARCH



APRIL



MARCH



APRIL



North Side Compound wall Reinforcement work is in progress

MARCH



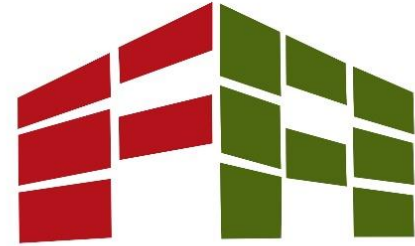

Felicity Adobe

Happy homes for all

THANK YOU

Happy homes for all